

Horizontal cassette cladding system (SZ-20)

• Description

Horizontal cassette system is used for horizontally aligned cassettes. The main vertical profiles are omega extrusions (profile Number 781 or ECI-1). Intermediate vertical omega profiles can also be used as reinforcements. The main profiles are fixed to the substructure of the building using U or double L - brackets.

• Fabrication of horizontal cassettes (SZ-20)

Following are the analytic steps for the fabrication of the horizontal cassettes (tray cassettes):

Routing of the cassette:

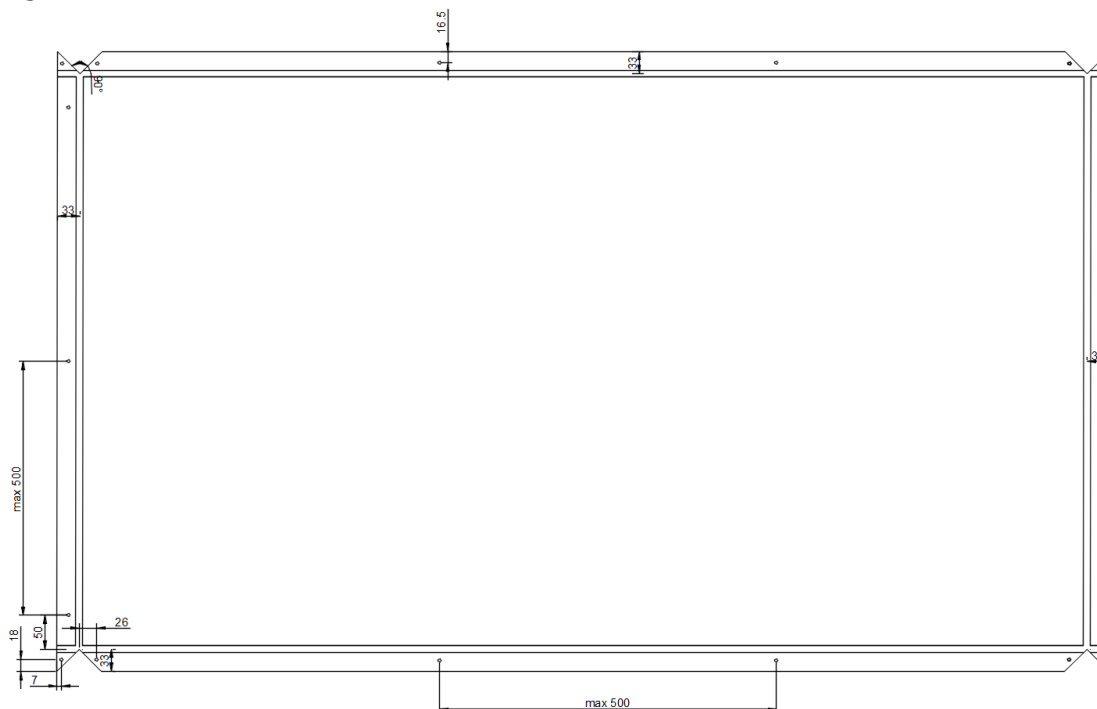

Formation of the horizontal tray cassettes: After the folding of the tray cassette, the following profiles are placed:

1. **“Z” profile, fixed with rivets to the top return folding of the tray cassette and also fixed to the substructure by rivets. For the most upper row of cassettes, the finish profile is placed instead of the Z profile**

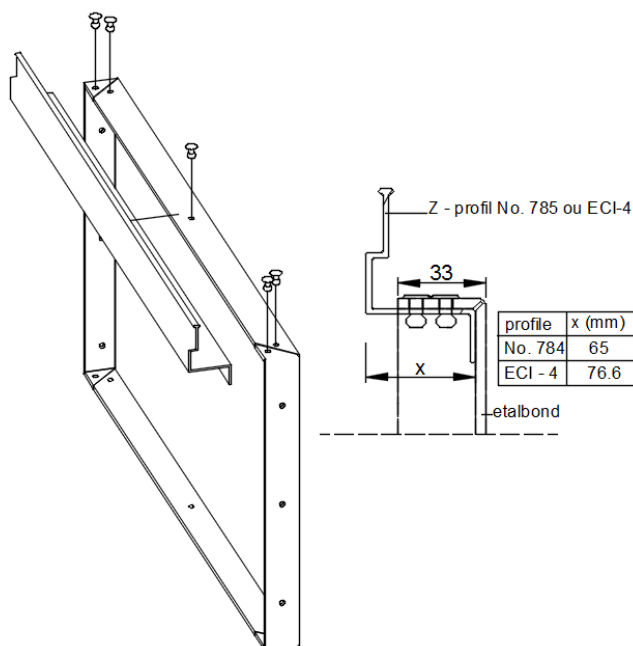

2. "S" profile, fixed to the bottom return folding of the tray cassette with rivets

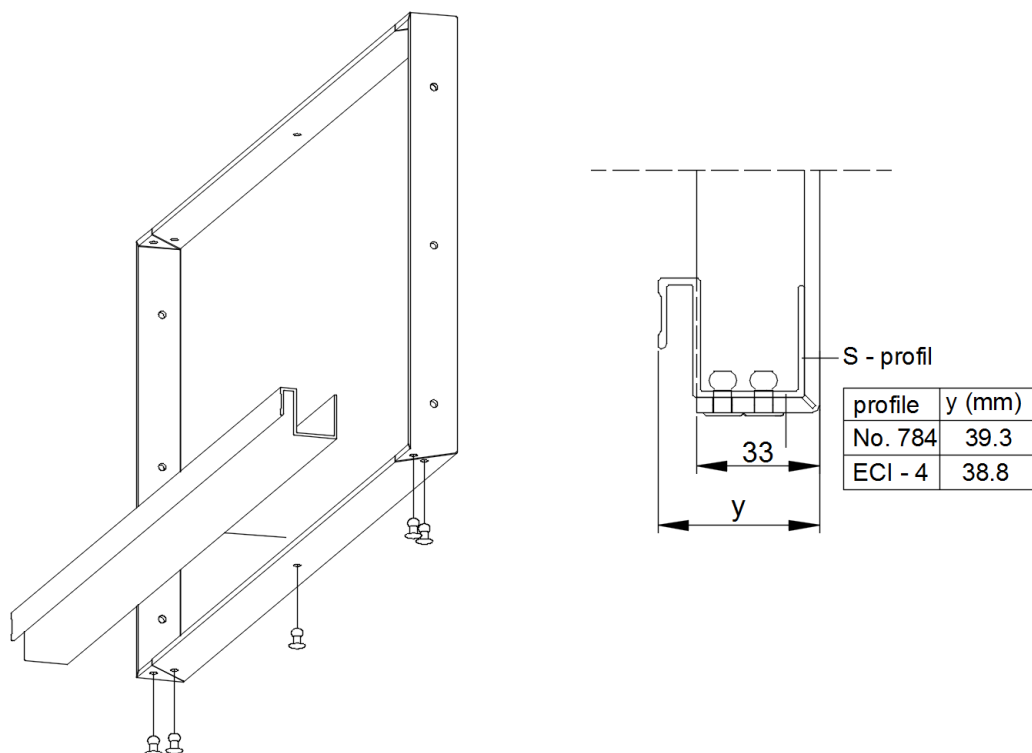

3. U - profiles, fixed to the side return foldings of the tray cassette but not fixed to the substructure

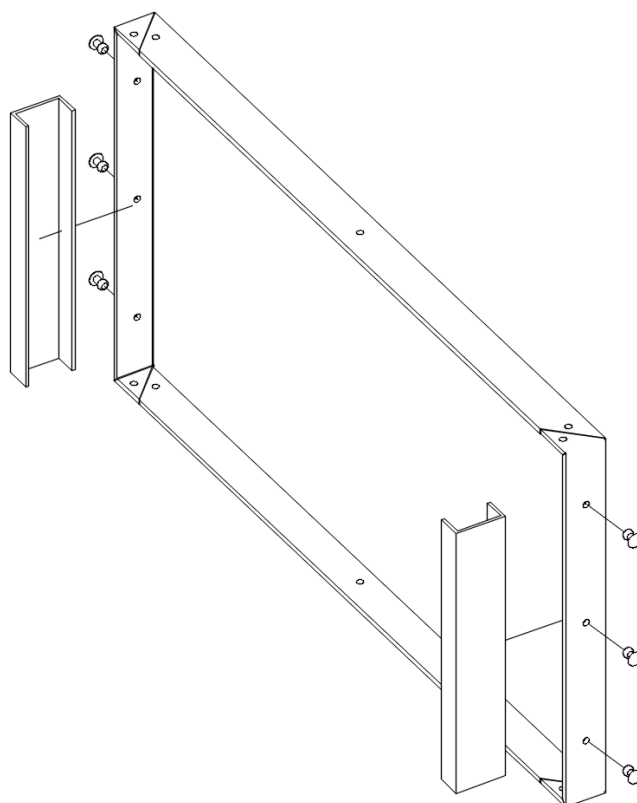

Horizontal layout of tray cassette system (SZ-20)

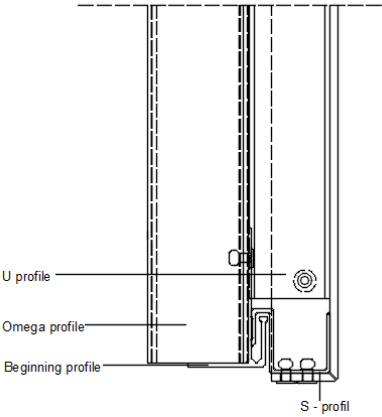
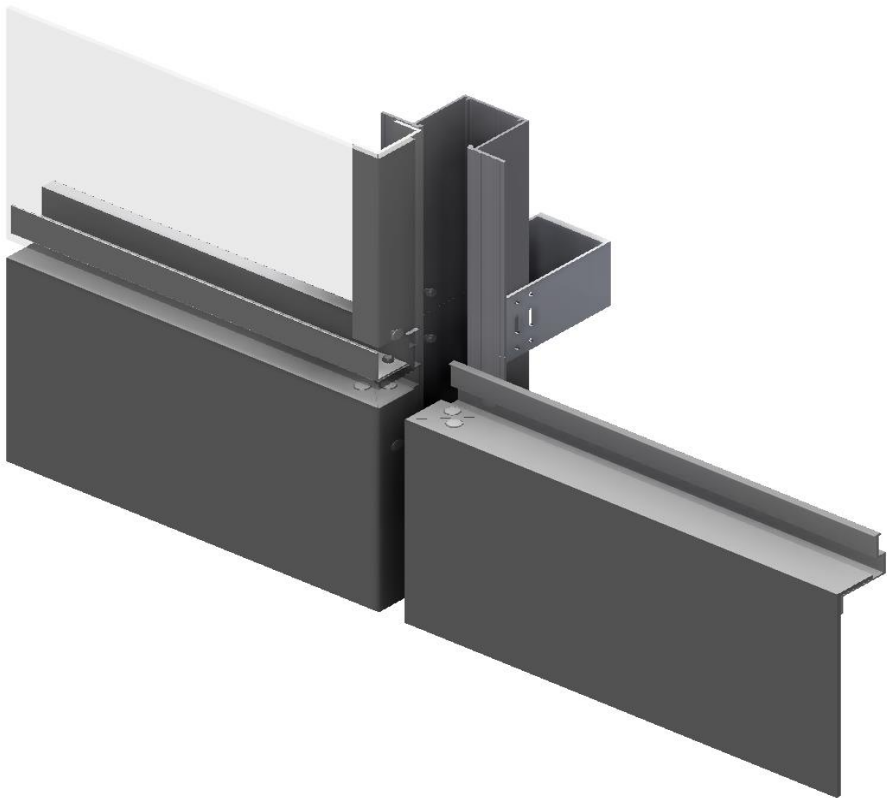

Vertical Section
Bottom detail

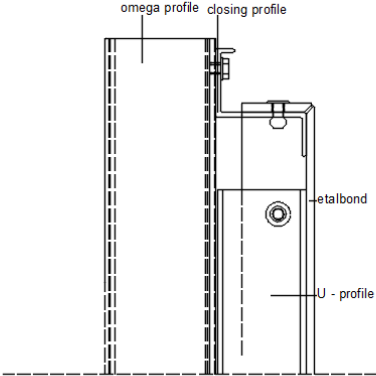

Vertical Section
Top detail

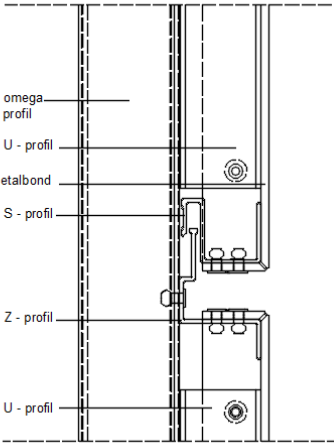

Vertical Section
Joint detail

Vertical Sections

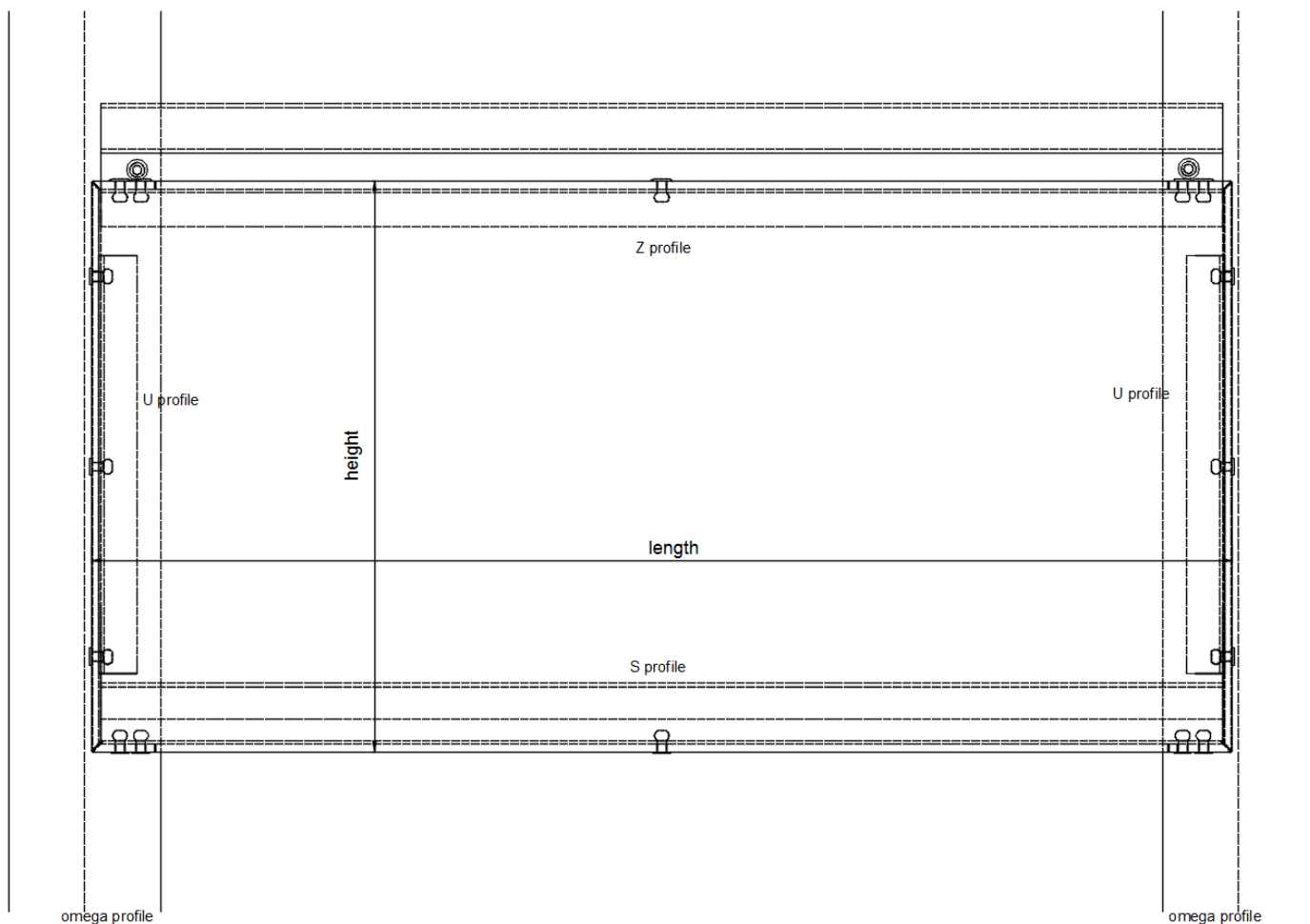

View

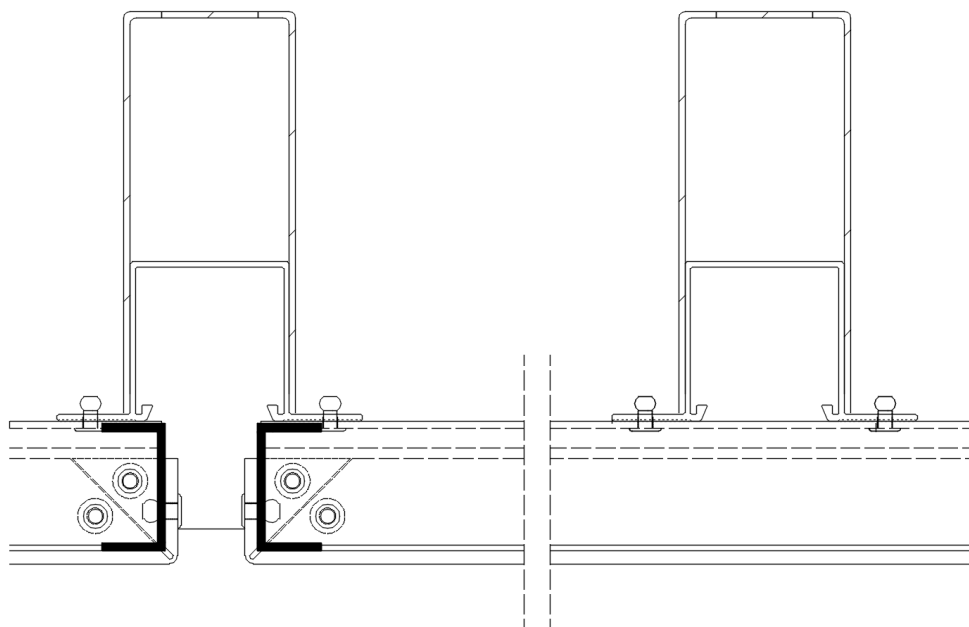

Horizontal Section (profile number 781)

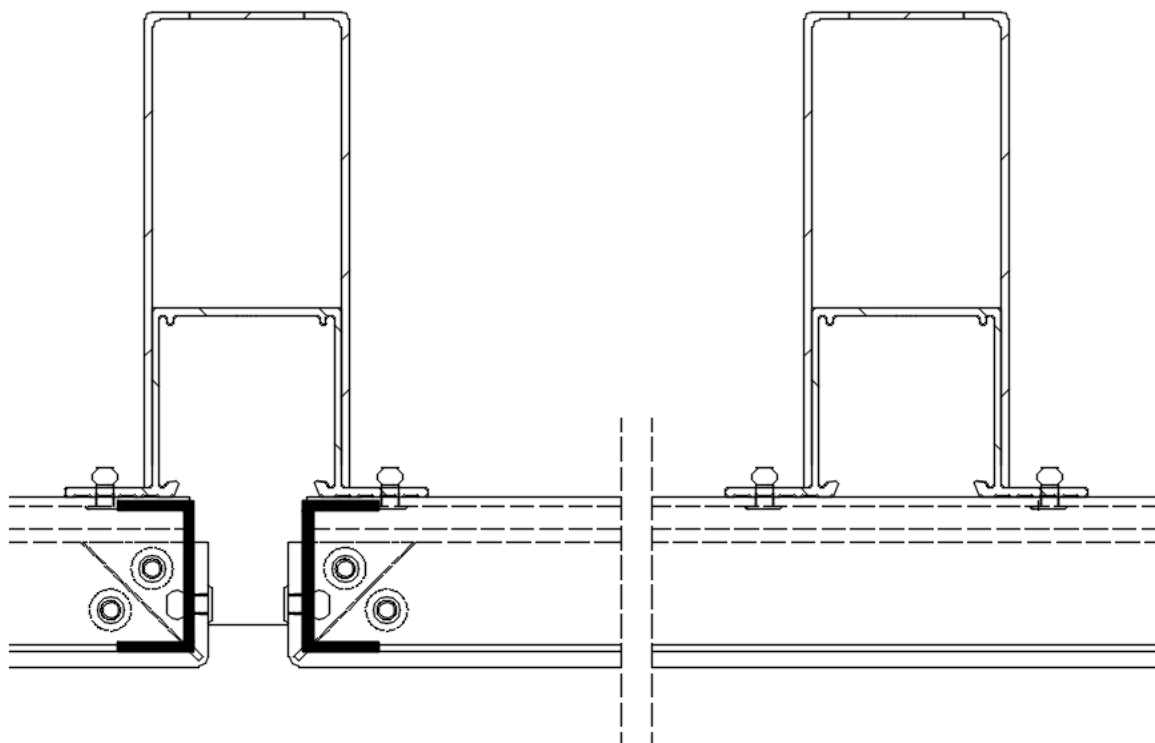

Horizontal Section (profile ECI-1)
